

- CONSTRUCTION DETAILS**
- INSTALL NEMA SIZE 'S' BASE MOUNTED CABINET ON EXTENDER BASE AND CONTROLLER WITH ALL OTHER NECESSARY EQUIPMENT (NOTE: 1-2 IN. AND 3-4 IN. SCH. 80 PVC BENDS). SEE GENERAL NOTE 24.
 - INSTALL 100 AMP METERED SERVICE PEDESTAL (NOTE: 3-2 IN. AND 1-4 IN. SCH. 80 PVC BENDS, CAP UNUSED CONDUITS). SEE GENERAL NOTE 24.
 - INSTALL CONCRETE FOUNDATION, 17 FT. STEEL POLE (15 FT. 'T' DIMENSION) WITH 50 FT. MAST ARM (CUT TO 42 FT.), LED SIGNAL HEADS WITH BACKPLATES, SIGNS, VIDEO DETECTION CAMERA WITH 5 FT. EXTENSION POLE, LED COUNTDOWN PEDESTRIAN SIGNAL HEADS, AUDIBLE/TACTILE PEDESTRIAN PUSHBUTTON, AND R10-3(1) SIGN TO READ "PUSH BUTTON TO CROSS GEORGIA AVE." (NOTE: 2-3 IN. SCH. 80 PVC BENDS; FINISH GRADE OF FOUNDATION SHALL BE FLUSH WITH WALKWAY).
 - INSTALL CONCRETE FOUNDATION, 17 FT. STEEL POLE (15 FT. 'T' DIMENSION) WITH 75 FT. MAST ARM, LED SIGNAL HEADS WITH BACKPLATES, VIBRATION MITIGATION DEVICE (MD 818.02-01, OPTION A), SIGN, AND VIDEO DETECTION CAMERAS WITH 5 FT. EXTENSION POLES (NOTE: 2-3 IN. SCH. 80 PVC BENDS).
 - INSTALL 14 FT. PEDESTAL POLE WITH BREAKAWAY TRANSFORMER BASE (MD 821.01-01), FOUNDATION (MD 801.01), AND SIDE MOUNTED LED SIGNAL HEAD (MD 814.03) WITH BACKPLATE. (NOTE: 1-2 IN. SCH. 80 PVC BEND).
 - INSTALL 10 FT. BREAKAWAY PEDESTAL POLE AND FOUNDATION (MD 801.01-01), LED COUNTDOWN PEDESTRIAN SIGNAL HEAD, AUDIBLE/TACTILE PEDESTRIAN PUSHBUTTON, AND R10-3(1) SIGN TO READ "PUSH BUTTON TO CROSS GEORGIA AVE." (NOTE: 1-2 IN. SCH. 80 PVC BEND).
 - INSTALL 10 FT. BREAKAWAY PEDESTAL POLE AND FOUNDATION (MD 801.01-01), LED COUNTDOWN PEDESTRIAN SIGNAL HEAD, AUDIBLE/TACTILE PEDESTRIAN PUSHBUTTON, AND R10-3(1) SIGN TO READ "PUSH BUTTON TO CROSS PRICE AVE." (NOTE: 1-2 IN. SCH. 80 PVC BEND).
 - ADJUST EXISTING UTILITY HANDBOX TO GRADE.
 - INSTALL ELECTRICAL HANDBOX WITH GROUND ROD.
 - INSTALL OVERSIZED ELECTRICAL HANDHOLE WITH GROUND ROD, CAP UNUSED CONDUITS.
 - INSTALL 4 IN. SCH. 80 PVC ELECTRICAL CONDUIT (SLOTTED).
 - INSTALL 4 IN. SCH. 80 PVC ELECTRICAL CONDUIT (TRENCHED).
 - INSTALL 3 IN. SCH. 80 PVC ELECTRICAL CONDUIT (TRENCHED).
 - INSTALL 2-3 IN. SCH. 80 PVC ELECTRICAL CONDUIT (TRENCHED).
 - INSTALL 2 IN. SCH. 80 PVC ELECTRICAL CONDUIT (TRENCHED).
 - INSTALL 4 IN. SCH. 80 PVC ELECTRICAL CONDUIT (TRENCHED) FOR PROPOSED UNDERGROUND POWER SERVICE. CAP AND MARK CONDUIT. LEAVE A 1 FT. STUB WITH PULL STRING AT UTILITY POLE FOR USE BY OTHERS.
 - INSTALL 3 IN. PVC RISER WITH WEATHERHEAD ON EXISTING UTILITY POLE (NO. 785439-2549) FOR PROPOSED INTERCONNECT AND REMOVE EXISTING SIGN 31.
 - INSTALL 24 IN. WHITE PREFORMED THERMOPLASTIC PAVEMENT MARKING LINE.
 - INSTALL GROUND MOUNTED SIGNS ON SQUARE PERFORATED TUBULAR STEEL SIGN POST.
 - INSTALL GROUND MOUNTED SIGN AS SHOWN ON PLAN ON 1-4" x 6" WOOD POST (SEE MD 813.01). (NOTE: MONTGOMERY COUNTY FORCES SHALL REMOVE FLAGS AND "NEW" SIGNS THREE (3) MONTHS AFTER INSTALLATION).
 - INSTALL 5 IN. CONCRETE SIDEWALK RAMP PER DETAIL ON SG-02.
 - CONSTRUCT MONOLITHIC MEDIAN (MD 645.01) WITH MEDIAN CUT-THROUGH (MD 655.21). SEE DETAIL ON SG-02.
 - REMOVE EXISTING SIDEWALK RAMP AND CONSTRUCT 5 FT. WIDE CONCRETE SIDEWALK RAMP WITH DETECTABLE WARNING SURFACE (MD 655.40) AND STD. TYPE A COMBINATION CURB & GUTTER. SEE GENERAL NOTE 24.
 - REMOVE EXISTING SIDEWALK RAMP AND CONSTRUCT 5 FT. WIDE SIDEWALK RAMP (MD 655.12) WITH DETECTABLE WARNING SURFACE (MD 655.40). RESTORE AREA OF RAMP REMOVAL WITH 5 IN. CONCRETE SIDEWALK AND TYPE A COMBINATION CURB & GUTTER.
 - AA. REMOVE EXISTING HANDHOLE, CAP AND ABANDON EXISTING CONDUIT.
 - BB. REMOVE EXISTING PAVEMENT MARKINGS.
 - CC. REMOVE EXISTING GROUND MOUNTED SIGN(S) AND SUPPORT.
 - DD. RELOCATE EXISTING STREETScape FURNITURE. SEE GENERAL NOTE 24.
 - EE. REMOVE EXISTING GROUND MOUNTED SIGN 37b AND REPLACE WITH PROPOSED GROUND MOUNTED SIGN 37a ON EXISTING SUPPORT.
 - FF. INSTALL ELECTRICAL HANDHOLE AND GROUND ROD. CONTRACTOR SHALL LOCATE AND INTERCEPT EXISTING CONDUIT.
 - GG. RELOCATE EXISTING GROUND MOUNTED SIGNS ON NEW SUPPORT.
 - HH. USE EXISTING HANDHOLE AND INSTALL NEW FRAME, COVER, AND GROUND ROD. ADJUST TO GRADE.

- GENERAL NOTES**
- MAINTENANCE OF TRAFFIC SHALL BE HANDLED BY THE CONTRACTOR UTILIZING MCDOT SHA STANDARD TYPICALS FOR TRAFFIC CONTROL.
 - THE CONTRACTOR SHALL CONTACT MISS UTILITY TO VERIFY ALL UNDERGROUND UTILITIES PRIOR TO THE INSTALLATION OF PROPOSED SIGNAL EQUIPMENT. IF ANY CONFLICTS ARISE, THE CONTRACTOR SHALL CONTACT THE PROJECT ENGINEER.
 - WITHIN 36 IN. OF UNDERGROUND UTILITY LOCATIONS, THE CONTRACTOR SHALL BE REQUIRED TO EXCAVATE FOR FOUNDATION AND CONDUIT BY HAND.
 - THE CONTRACTOR SHALL REMOVE AND DISPOSE OF ALL ABANDONED ELECTRICAL CABLES.
 - THE CONTRACTOR SHALL BE RESPONSIBLE FOR ROUTING AND PROPERLY LABELING ALL SIGNAL CABLES. ALL INTERNAL CABINET WIRING SHALL BE PERFORMED BY MCDOT FORCES.
 - ALL SIGNAL POLE AND CABINET FOUNDATIONS SHALL BE INSTALLED AT THE FINAL SIDEWALK OR CURB GRADE TO MEET CLEARANCES AS SPECIFIED IN MD 816.07, MD 818.01, AND MD 801.01-01. THE CONTRACTOR SHALL VERIFY ULTIMATE GRADES PRIOR TO THE INSTALLATION OF ALL SIGNAL EQUIPMENT. THE TOP OF THE SIGNAL POLE FOUNDATION SHALL NOT BE LOWER THAN THE CROWN OF THE ROAD.
 - THE CONTRACTOR SHALL INTEGRATE PROPOSED CONCRETE FOUNDATIONS WITH NEW CURBSIDEWALK RAMPS WHERE NECESSARY.
 - THE CONTRACTOR IS TO MAINTAIN PEDESTRIAN ACCESS DURING CONSTRUCTION STAGES.
 - THE CONTRACTOR SHALL COORDINATE VIDEO CAMERA LOCATION AND ALIGNING WITH THE MCDOT ENGINEER.
 - THE CONTRACTOR SHALL VERIFY ALL PUSHBUTTONS LOCATIONS PRIOR TO THEIR INSTALLATION.
 - PUSHBUTTONS ARE TO BE LOCATED SO THAT THEY CAN BE ACTIVATED BY A PERSON IN A WHEELCHAIR REACHING LESS THAN 18" FROM A 60" x 60" LEVEL LANDING AREA WITH A CROSS SLOPE OF LESS THAN OR EQUAL TO 2%.
 - PUSHBUTTONS ARROWS ARE TO BE PARALLEL TO THE CROSSING FOR WHICH THEY ARE INTENDED.
 - IF THE LOCATION OF THE ACCESSIBLE PEDESTRIAN SIGNAL (APS) PUSHBUTTONS MUST BE CHANGED, THE CONTRACTOR SHALL NOTIFY THE PROJECT ENGINEER TO OBTAIN APPROVAL FOR THE NEW LOCATION TO ENSURE MUTCD SEC 4E.08, 4E.10, FIG. 4E-3, 4E-4, AND ALL NCHRP REQUIREMENTS ARE MET. ALL WORK MUST BE HALTED UNTIL THE PROJECT ENGINEER HAS OBTAINED AN APPROVED LOCATION OR A DESIGN WAIVER IS OBTAINED.
 - THE 10' SEPARATION BETWEEN PUSHBUTTONS IS TO BE MEASURED FROM THE FACE OF PUSHBUTTON TO FACE OF PUSHBUTTON, NOT CENTER TO CENTER OF POLES.
 - THE CONTRACTOR SHALL DELIVER THE CABINET TO THE MONTGOMERY COUNTY SIGNAL SHOP FOR PROGRAMMING AND TESTING. CONTACT MR. KAMAL HAMUD, AT 240-777-8761, TO COORDINATE. THE CONTRACTOR SHALL ENSURE ALL NECESSARY AUXILIARY EQUIPMENT IS SUPPLIED BY MANUFACTURER FOR USE BY MCDOT.
 - THE CONTRACTOR SHALL INSTALL CONDUIT PRIOR TO NEW SIDEWALK AND RAMP CONSTRUCTION.
 - ALL CROSSWALK DIMENSIONS ARE GIVEN AS OUT TO OUT MEASUREMENTS.
 - SEE SHEET SG-02 FOR MAST ARM EQUIPMENT LAYOUT DIAGRAM.
 - ALL PAVEMENT MARKINGS SHALL BE INSTALLED IN ACCORDANCE WITH MCDOT SHA STANDARDS.
 - ALL CROSSWALKS SHALL BE CENTERED ON THE LEVEL LANDING AREA OF THE PROPOSED RAMPS.
- GENERAL NOTES (CONT.)**
- THE CONTRACTOR SHALL DELIVER APS PUSHBUTTONS AND CENTRAL CONTROL UNIT TO MR. STEVE YOUNG AND MR. GREG WHITENER AT MONTGOMERY COUNTY TECHNICAL CENTER AT LEAST 3 WEEKS PRIOR TO BEGINNING WORK.
 - THE CONTRACTOR SHALL ADJUST THE CURB AND GUTTER ADJACENT TO THE EXISTING DRIVEWAY TO BE REMOVED TO ENSURE POSITIVE DRAINAGE.
 - 5 FT. EXTENSION POLES SHALL BE INCIDENTAL TO THE FURNISH AND INSTALL VIDEO DETECTION CAMERA ITEM.
 - CONTRACTOR SHALL REMOVE AND RESET EXISTING BRICK PAVEMENT SIDEWALK AS NECESSARY TO FACILITATE REMOVAL AND CONSTRUCTION OF PROPOSED TRAFFIC SIGNAL EQUIPMENT. RESET OF BRICK PAVEMENT SHALL MATCH EXISTING PATTERN.
 - CONTRACTOR SHALL COORDINATE WITH MONTGOMERY COUNTY PARKING DIVISION FOR REMOVAL OF EXISTING PARKING METERS.
 - SIGNAL ACTIVATION SHALL BE SCHEDULED THROUGH THE MARYLAND DEPARTMENT OF TRANSPORTATION STATE HIGHWAY ADMINISTRATION, OFFICE OF TRAFFIC AND SAFETY, TRAFFIC OPERATIONS DIVISION. ALL NEW SIGNALS SHALL BE INSTALLED, INSPECTED, SATISFACTORILY TESTED, AND THEIR OPERATION BE ACCEPTED AND APPROVED BY THE TRAFFIC OPERATIONS DIVISION.
 - THE CONTRACTOR SHALL ORIENT THE ANCHOR BOLTS IN THE FOUNDATION ACCORDING TO THE RADIAL INDEX NOTED ON THE APPROVED SHOP DRAWINGS, THE NOTED ANCHOR BOLT ORIENTATION SHALL BE ROTATED TO MEET THE MAST ARM ORIENTATION SHOWN ON THE TRAFFIC SIGNAL PLANS.
 - THE CONTRACTOR SHALL ENSURE A MINIMUM OF 17 FT. AND MAXIMUM OF 19 FT. CLEARANCE FROM THE HIGH POINT OF THE ROADWAY TO THE LOW POINT OF SIGNAL HEAD ASSEMBLIES.



UTILITY LEGEND

—E—E—	ELECTRIC CABLES	—S—S—	SEWER MAIN
—A—A—	AERIAL CABLES	—G—G—	GAS MAIN
—T—T—	TELEPHONE CABLES	—W—W—	WATER MAIN
—F—F—	FIBER-OPTIC	—SAN—SAN—	SEWER MAIN

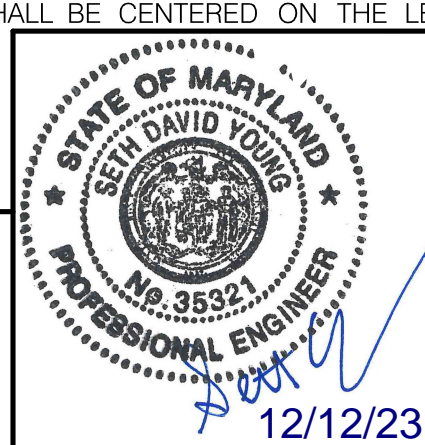

"I HEREBY CERTIFY THAT THESE DOCUMENTS WERE PREPARED OR APPROVED BY ME AND THAT I AM A DULY LICENSED PROFESSIONAL ENGINEER UNDER THE LAWS OF THE STATE OF MARYLAND.
 LICENSE NO. 35321
 EXPIRATION DATE JANUARY 6, 2024

APPROVALS	REVISIONS
TEAM LEADER	
ASST. DIV. CHIEF	
DIVISION CHIEF	
OFFICE DIRECTOR	

SIGNALIZATION PLAN SHEET

SCALE 1" = 20' ADVERTISED DATE _____ CONTRACT NO. _____

DESIGNED BY K. MISNER COUNTY MONTGOMERY
 DRAWN BY K. MISNER LOGMILE 15009703.37
 CHECKED BY M. GUILIANO TMS NO. P037
 MDE/PRD _____ TOD NO. _____

TS NO. 5264 DRAWING SG-01 OF 04 SHEET NO. 1 OF 4

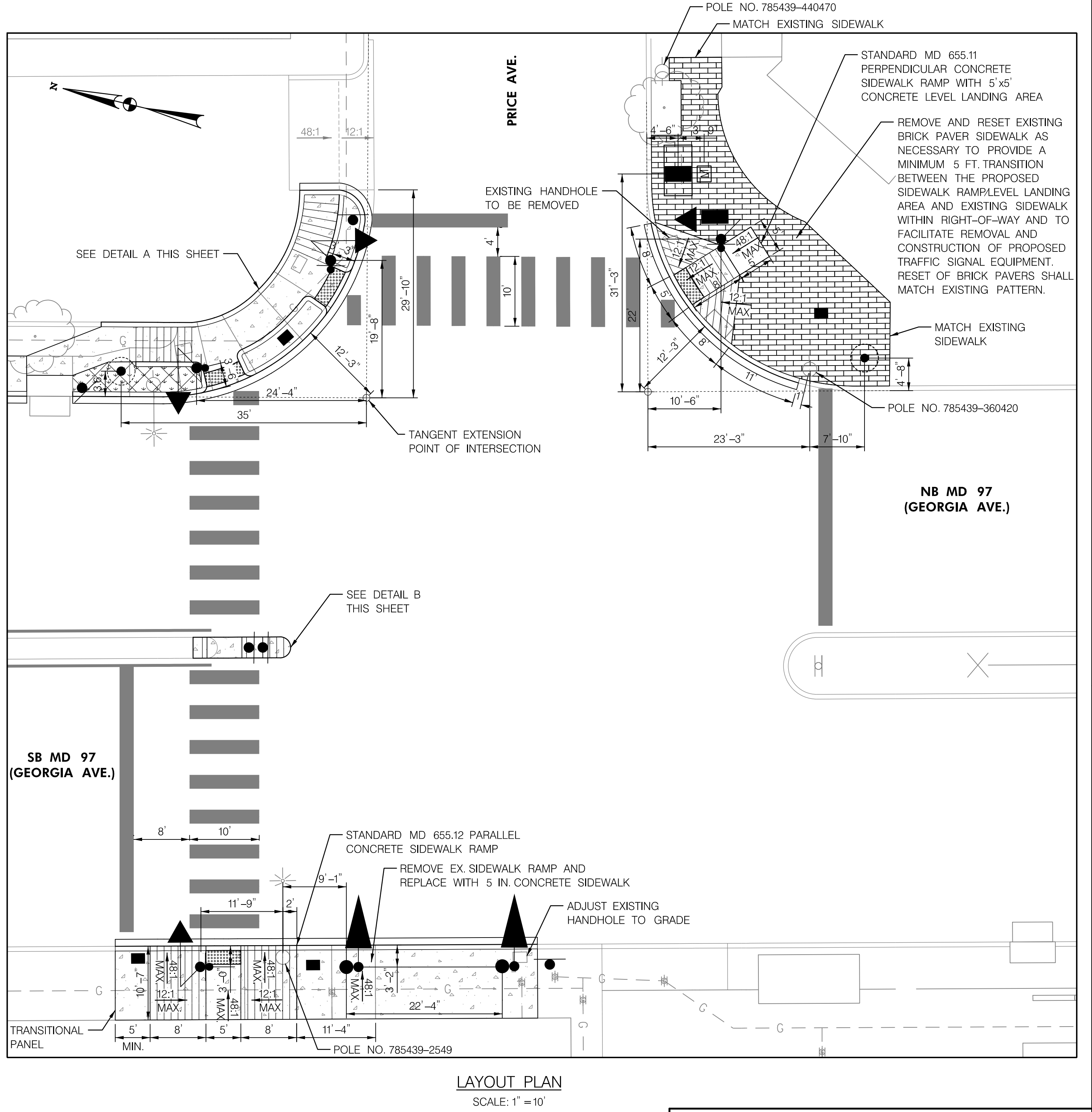
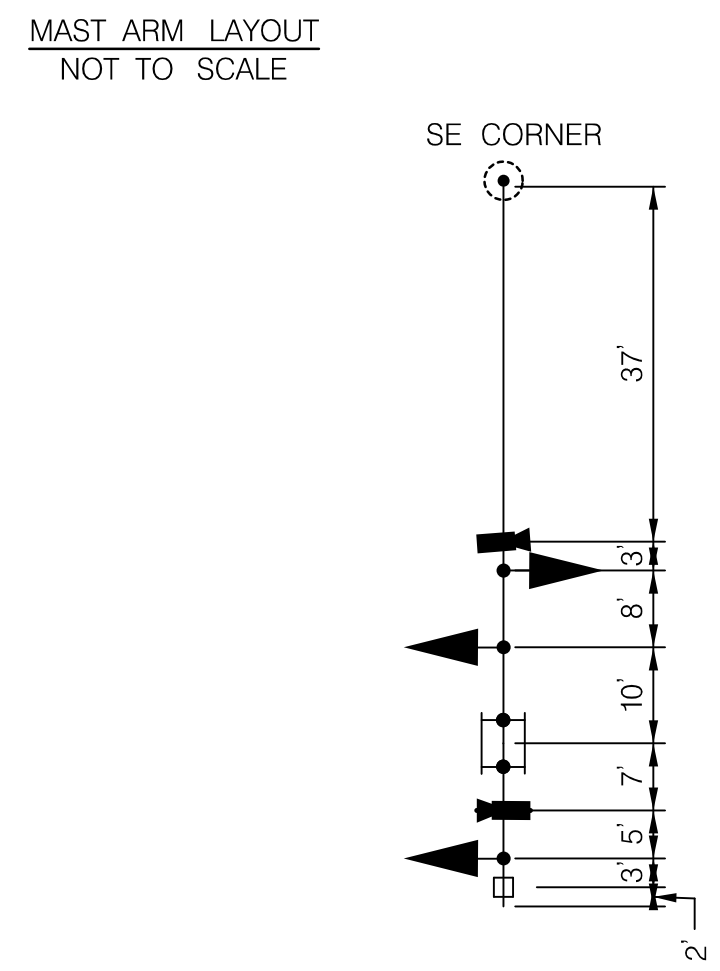
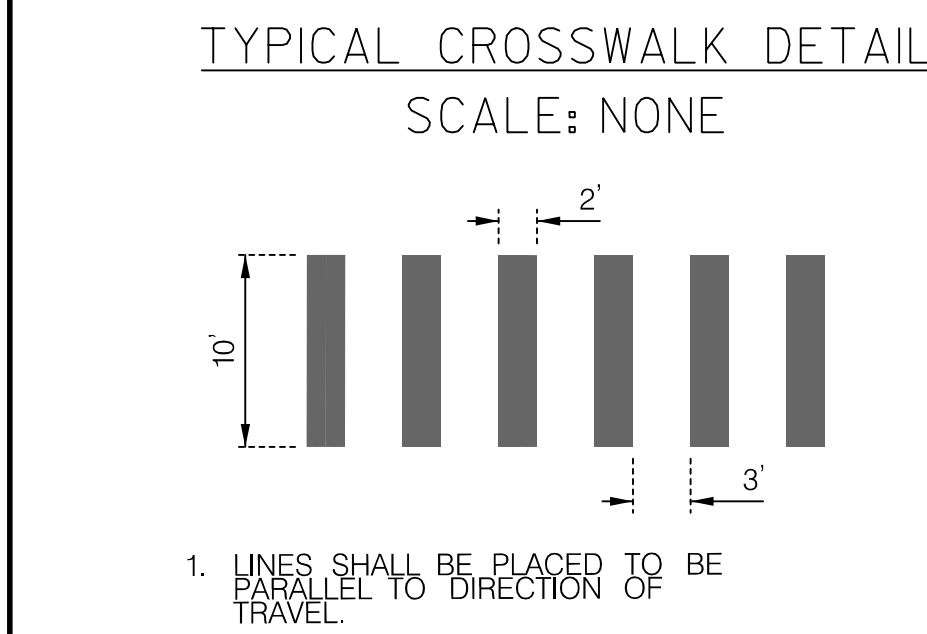
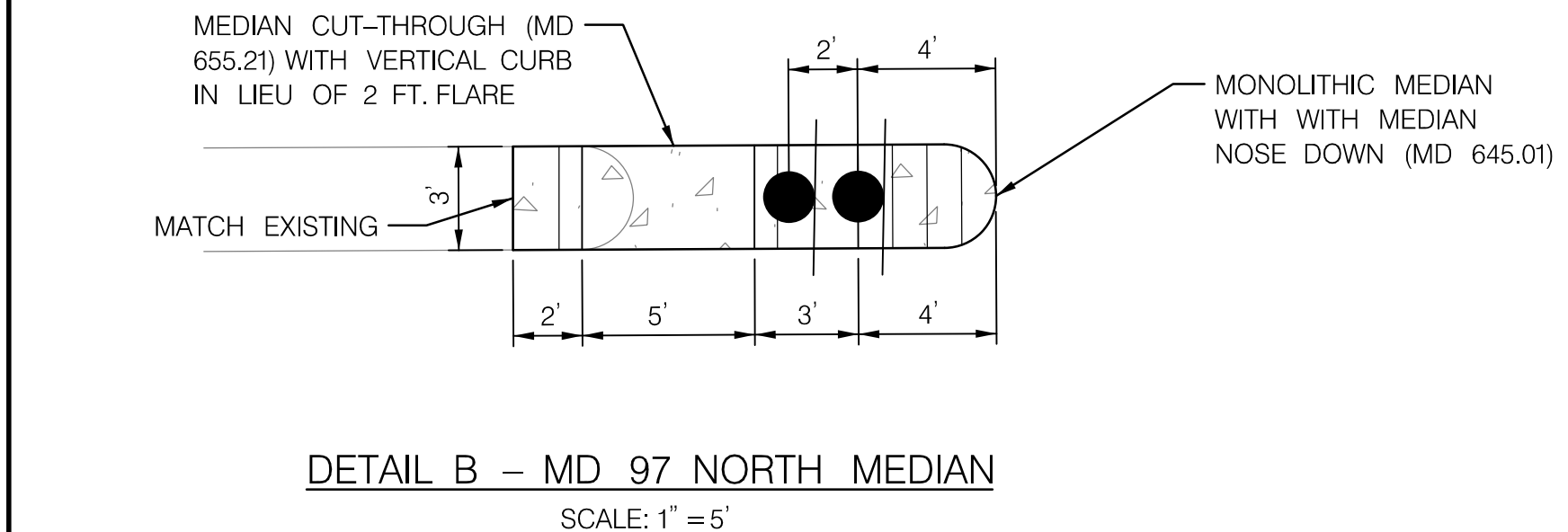
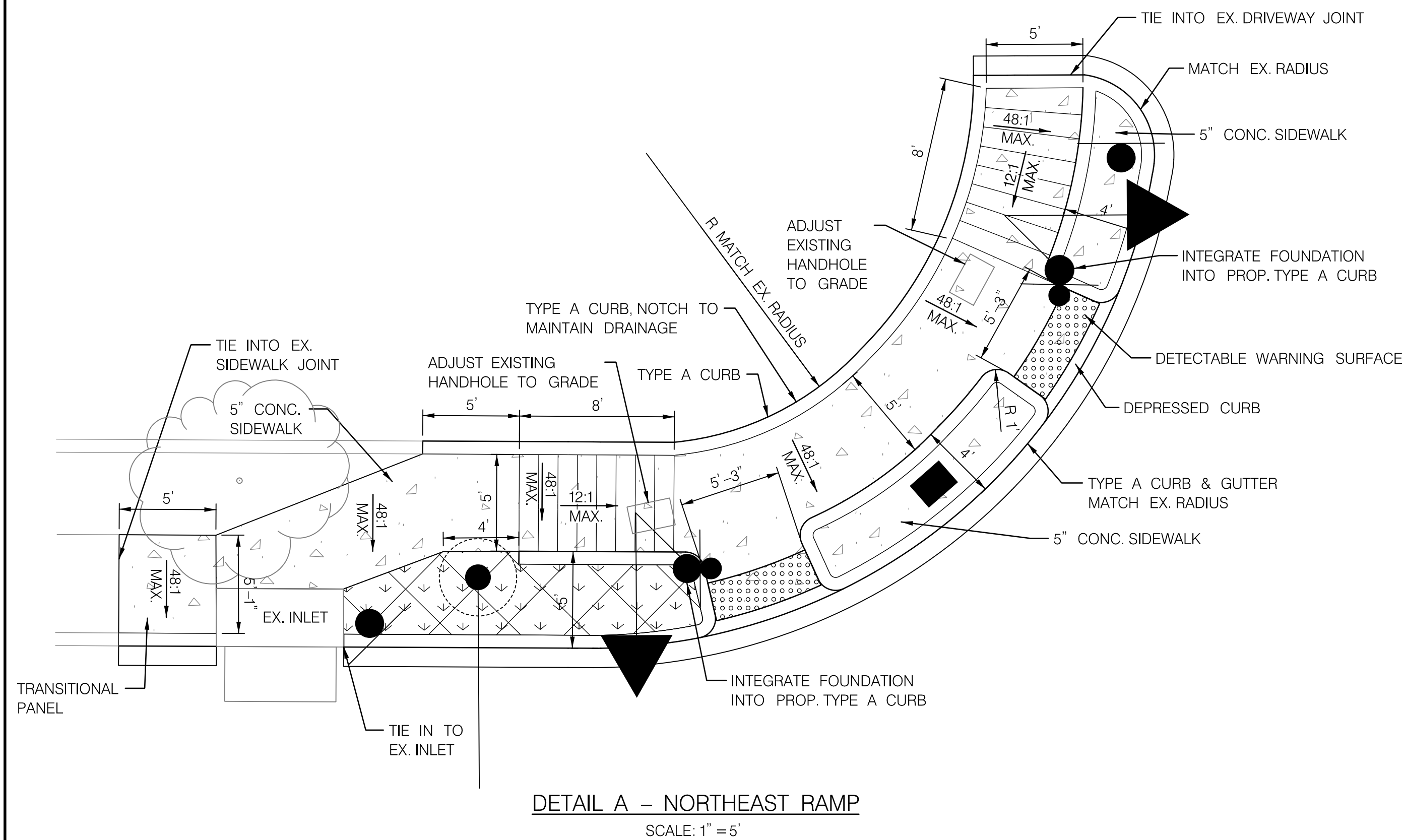

LEGEND

- CONCRETE SIDEWALK
- DETECTABLE WARNING SURFACE
- BRICK SIDEWALK
- REMOVAL OF EXISTING SIDEWALK

ACCESS PERMIT NUMBER 20APMO037XX.
 IF CONSTRUCTION IS NOT STARTED WITHIN ONE YEAR OF APPROVAL,
 CONSTRUCTION SHALL NOT START UNTIL PLANS ARE REAPPROVED.

STATE OF MARYLAND
 SEIN DAVID YOUNG
 PROFESSIONAL ENGINEER
 No. 35321
 12/12/23

"I HEREBY CERTIFY THAT THESE DOCUMENTS WERE PREPARED OR APPROVED BY ME, AND THAT I AM A DULY LICENSED PROFESSIONAL ENGINEER UNDER THE LAWS OF THE STATE OF MARYLAND."
 LICENSE NO. 35321
 EXPIRATION DATE JANUARY 6, 2024

OFFICE OF TRAFFIC & SAFETY
 TRAFFIC ENGINEERING DESIGN DIVISION

MDOT
 MARYLAND DEPARTMENT OF TRANSPORTATION
 STATE HIGHWAY ADMINISTRATION

MD 97 (GEORGIA AVENUE) AND PRICE AVENUE
 WHEATON, MARYLAND

GENERAL INFORMATION SHEET

SCALE AS SHOWN ADVERTISED DATE _____ CONTRACT NO. _____

DESIGNED BY K. MISNER COUNTY MONTGOMERY
 DRAWN BY K. MISNER LOGMILE 15009703.37
 CHECKED BY M. GUILIANO TMS NO. P037
 MDE/PRD TOD NO. _____

TS NO. 5264 DRAWING **SG-02** OF 04 SHEET NO. 2 OF 4



PROJECT DESCRIPTION

GENERAL

THIS PROJECT INVOLVES THE INSTALLATION OF A NEW TRAFFIC SIGNAL AT THE INTERSECTION OF MD 97 (GEORGIA AVENUE) AND PRICE AVENUE IN MONTGOMERY COUNTY. THE EXISTING SIGNED AND MARKED PEDESTRIAN CROSSINGS WILL BE REPLACED WITH NEW APS/CPSS SIGNALIZED CROSSINGS ON THE NORTH AND EAST LEGS.

MD 97 IS ASSUMED TO RUN IN A NORTH-SOUTH DIRECTION.

INTERSECTION OPERATION

THE INTERSECTION WILL OPERATE IN A NEMA 3 PHASE, SEMI-TRAFFIC ACTUATED MODE. VIDEO PRESENCE DETECTION IS PROPOSED FOR PRICE AVENUE. VIDEO SETBACK DETECTION IS PROPOSED ALONG NORTHBOUND AND SOUTHBOUND MD 97. PEDESTRIAN PHASING CROSSING PRICE AVENUE IS PROPOSED TO RUN CONCURRENTLY WITH THE PHASE 2, NORTHBOUND MD 97 MOVEMENT. PEDESTRIAN PHASING CROSSING MD 97 IS PROPOSED TO RUN AS AN ALTERNATE PHASE 4, CONCURRENTLY WITH THE EASTBOUND PRICE AVENUE MOVEMENT. A LEADING PEDESTRIAN INTERVAL (LPI) WILL BE PROVIDED FOR THE NORTH LEG CROSSING.

CONTROLLER REQUIREMENTS

INSTALL A NEW EIGHT PHASE FULLY ACTUATED TRAFFIC SIGNAL ASC 3 CONTROLLER, IP-BASED VIDEO DETECTION INTERFACE, 2-WIRE CENTRAL CONTROL UNIT, AND ASSOCIATED HARNESSSES IN A NEMA SIZE 'S' BASE MOUNTED CABINET ON A CABINET EXTENSION BASE.

INTERCONNECT

EXISTING INTERCONNECT RUNS FROM THE EXISTING TRAFFIC SIGNAL CONTROLLER CABINET AT MD 97 AND REEDIE DRIVE, OVERHEAD ALONG THE WEST SIDE OF MD 97 TO THE EXISTING TRAFFIC SIGNAL CONTROLLER CABINET AT MD 97 AND MD 193. IT IS PROPOSED TO DISCONNECT THE EXISTING IC CABLE FROM THE CABINET AT MD 97 AND MD 193 AND REROUTE THE CABLE INTO THE NEW TRAFFIC SIGNAL CONTROLLER CABINET AT MD 97 AND PRICE AVENUE. NEW OVERHEAD IC CABLE WILL BE INSTALLED FROM THE NEW TRAFFIC SIGNAL CONTROLLER CABINET AT MD 97 AND PRICE AVENUE TO EXISTING TRAFFIC SIGNAL CONTROLLER CABINET AT MD 193. SEE INTERCONNECT PLAN FOR DETAILS.

APS OPERATION

FOR MD 97 (GEORGIA AVE.)

- A. WHEN PEDESTRIAN LOCATES AND PRESSES PUSHBUTTON FOR AN EXTENDED TIME, THE PUSHBUTTON UNIT WILL BE "WAIT TO CROSS GEORGIA AT PRICE, WAIT"
- B. WHEN WALK PHASE BEGINS, THE MESSAGE WILL BE A RAPID TICK WHICH WILL LAST FOR THE DURATION OF THE WALK PHASE.

FOR PRICE AVE.

- A. WHEN PEDESTRIAN LOCATES AND PRESSES PUSHBUTTON FOR AN EXTENDED TIME, THE PUSHBUTTON UNIT WILL BE "WAIT TO CROSS PRICE AT GEORGIA, WAIT"
- B. WHEN WALK PHASE BEGINS, THE MESSAGE WILL BE A RAPID TICK WHICH WILL LAST FOR THE DURATION OF THE WALK PHASE.

CONTACTS

THE CONTACT PERSONS FOR DISTRICT 3 ARE AS FOLLOWS:

MR. DEREK GUNN
DISTRICT ENGINEER
301-513-7498

VACANT
ASSISTANT DISTRICT ENGINEER-TRAFFIC
301-513-7462

MR. MARK LOEFFLER
DISTRICT UTILITY ENGINEER
301-513-7350

MR. GREGORY EDWARDS
ADE-MAINTENANCE (MONTGOMERY COUNTY)
301-513-7304

VACANT
ADE-CONSTRUCTION (FIELD)
301-513-7336

MR. SAMUEL AIMUFUA
DISTRICT OPERATIONS ENGINEER
301-513-7307

CONTACTS (CONT.)

THE CONTACT PERSONS FOR THE OFFICE OF TRAFFIC AND SAFETY ARE AS FOLLOWS:

REBECCA LICHTENSTEIN, P.E.
CHIEF TRAFFIC OPERATIONS DIVISION
410-787-7630

MR. ANTOINE YATES
ASSISTANT DIVISION CHIEF
TRAFFIC OPERATIONS DIVISION
410-787-7645

MR. MICHAEL BASSO
CHIEF SIGNAL OPERATIONS SECTION
410-365-7258

MR. MIKE BOYLE
SIGNAL SHOP SUPPLY OFFICER
410-787-7673

THE CONTACT PERSONS FOR MONTGOMERY COUNTY ARE AS FOLLOWS:

MR. STEVE YOUNG & MR. GREG WHITENER
MONTGOMERY COUNTY SIGNAL OPERATIONS
MANAGER
301-279-1291

MR. KAMAL HAMUD
MONTGOMERY COUNTY TMC CENTER
240-777-8761

THE POWER COMPANY REPRESENTATIVE IS:
POTOMAC ELECTRIC POWER COMPANY
MR. JACK CHU, CUSTOMER DESIGN
201 WEST GUDE DRIVE
ROCKVILLE, MARYLAND, 20850
301-548-4332

EQUIPMENT LIST

EQUIPMENT TO BE FURNISHED AND INSTALLED BY THE CONTRACTOR

CAT. CODE	ITEM NO.	QUANTITY	DESCRIPTION
120500	1001	28 DAYS	MAINTENANCE OF TRAFFIC (MOT)
203030	2002	14 CY	TEST PIT EXCAVATION
549800	5000	445 LF	REMOVAL OF EXISTING PAVEMENT MARKINGS, ANY WIDTH
634312	5000	260 LF	STANDARD TYPE A CURB, 6"x 14"
655105	5000	1125 SF	5" CONCRETE SIDEWALK, MIX NO. 2
648120	5014	15 LF	MONOLITHIC CONCRETE MEDIAN TYPE A (4'-0" WIDE)
600000	5015	5 LF	REMOVAL OF EXISTING MEDIAN, 2'-4" WIDTH
655390	5018	102 SY	REMOVE AND RESET ORNAMENTAL BRICK SIDEWALK
210025	5019	5 SY	REMOVAL OF EXISTING PAVEMENT
600000	5021	210 LF	REMOVAL OF CURB
210026	5022	930 SF	REMOVAL OF SIDEWALK
971043	8000	1 EA	CABINET EXTENSION BASE, SIZE "S"
871202	8000	1 EA	FURNISH AND INSTALL MSHA STANDARD NEMA SIZE "S" SIGNAL CABINET AND AUXILIARY EQUIPMENT
801106	8000	40 LF	WOOD SIGN SUPPORTS (4"x 6")
802145	8000	3 EA	ADJUST EXISTING HANDHOLE
805032	8000	30 LF	3" POLYVINYL CHLORIDE RISER
811000	8000	1 EA	OVERSIZED ELECTRICAL HANDHOLE
800000	8000	1 EA	MAST ARM VIBRATION MITIGATION DEVICE
801004	8001	10 CY	CONCRETE FOUNDATION
805125	8019	115 LF	2" POLYVINYL CHLORIDE ELECTRICAL CONDUIT (SCHEDULE 80) (TRENCHED)
805135	8023	75 LF	3" POLYVINYL CHLORIDE ELECTRICAL CONDUIT (SCHEDULE 80) (TRENCHED)
805140	8027	60 LF	4" POLYVINYL CHLORIDE ELECTRICAL CONDUIT (SCHEDULE 80) (TRENCHED)
805155	8029	155 LF	4" POLYVINYL CHLORIDE ELECTRICAL CONDUIT (SCHEDULE 80) (SLOTTED)
807207	8035	1 EA	200 AMP, 120/240VOLT, 1 PHASE, 3 WIRE ELECTRICAL SERVICE PEDESTAL AND CONCRETE COLLAR
837001	8036	9 EA	GROUND ROD, 3/4" DIAMETER X 10' LENGTH WITH CLAMP
861105	8057	525 LF	2-CONDUCTOR ELECTRICAL CABLE (NO. 14 AWG) IMSA 19-1
861106	8059	455 LF	3-CONDUCTOR ELECTRICAL CABLE (NO. 18 AWG) VIDEO DETECTION CABLE
861107	8060	825 LF	5-CONDUCTOR ELECTRICAL CABLE (NO. 14 AWG) IMSA 19-1
861108	8061	860 LF	7-CONDUCTOR ELECTRICAL CABLE (NO. 14 AWG) IMSA 19-1
810014	8067	30 LF	1-CONDUCTOR ELECTRICAL CABLE (NO. 8 AWG) THWN
802501	8069	370 LF	1-CONDUCTOR ELECTRICAL CABLE (NO. 6 AWG) STRANDED BARE COPPER GROUND WIRE
802571	8074	645 LF	1-CONDUCTOR ELECTRICAL CABLE 20 THWN - ALUMINUM
801130	8077	6 EA	GALVANIZED STEEL POST, 2" x 12" PIPE
801605	8081	8 EA	FURNISH AND INSTALL >0 TO <=5 SF (OVERHEAD OR POST)
801605	8082	8 EA	FURNISH AND INSTALL >5 TO <=25 SF (OVERHEAD OR POST)
800000	8097	1 EA	FURNISH AND INSTALL MSHA STANDARD ASC 3 CONTROLLER
818036	8102	2 EA	FURNISH AND INSTALL STANDARD STEEL SPECIAL "T" MAST ARM
818010	8105	2 EA	FURNISH AND INSTALL MSHA STANDARD 14' PEDESTAL POLE WITH TRANSFORMER BASE
818004	8106	4 EA	FURNISH AND INSTALL MSHA STANDARD 10' PEDESTAL POLE WITH BREAKAWAY COUPLINGS
805050	8109	1 EA	FURNISH AND INSTALL 3" WEATHER HEAD
862305	8119	1 EA	FURNISH AND INSTALL BACK GUY
811001	8131	4 EA	FURNISH AND INSTALL SIGNAL HANDBOX (PULLBOX) LARGE SIZE (24" x 30")
860292	8140	1 EA	CUT MAST ARM TO NEEDED LENGTH
813023	8144	6 EA	RELOCATE SIGN
801711	8149	21 EA	REMOVAL AND SALVAGE OF SIGNS LESS THAN 50 SF
811002	8162	1 EA	REMOVAL OF SIGNAL HANDBOX
865210	8166	4 EA	FURNISH AND INSTALL AUDIBLE PEDESTRIAN PUSH BUTTON ASSEMBLY & PUSH BUTTON SIGNS
865300	8167	1 EA	FURNISH AND INSTALL 2-WIRE ACCESSIBLE PEDESTRIAN (APS) CENTRAL CONTROL UNIT
860284	8168	8 EA	FURNISH 12" LED POLYCARBONATE SIGNAL HEAD (R,Y,G) WITH BLACK FACE TUNNEL VISORS (INCLUDES LENS, LED, AND MOUNTING HARDWARE)
860285	8172	4 EA	FURNISH 16" 1-SECTION FULL HAND, FULL PERSON LED PEDESTRIAN SIGNAL WITH COUNTDOWN
655120	8175	4 EA	FURNISH AND INSTALL MSHA STANDARD DETECTABLE WARNING SURFACE
816001	8176	3 EA	FURNISH AND INSTALL VIDEO DETECTION CAMERA
816015	8177	1 EA	FURNISH AND INSTALL DETECTION CAMERA INTERFACE EQUIPMENT (1-8) CAMERA
860289	8181	8 EA	FURNISH AND INSTALL SIGNAL HEAD BACKPLATE
549419	8190	330 LF	FURNISH AND INSTALL 24" WHITE HEAT APPLIED PERMANENT PREFORMED THERMOPLASTIC PAVEMENT MARKING

PHASE CHART

	1	2	3	4	5	6	7	8	9	10	11	12
	(R) (Y) (G)	(R) (Y) (G)	(R) (Y) (G)	(R) (Y) (G)	(R) (Y) (G)	(R) (Y) (G)	(R) (Y) (G)	(R) (Y) (G)	(R) (Y) (G)	(R) (Y) (G)	(R) (Y) (G)	(R) (Y) (G)
PHASE 2 AND 6	G	G	G	G	G	G	R	R	WK	WK	DW	DW
PED CLEARANCE	G	G	G	G	G	G	R	R	FL/DW	FL/DW	DW	DW
PHASE 2 AND 6 CHANGE	Y	Y	Y	Y	Y	Y	R	R	DW	DW	DW	DW
PHASE 4	R	R	R	R	R	R	G	G	DW	DW	DW	DW
PHASE 4 CHANGE	R	R	R	R	R	R	Y	Y	DW	DW	DW	DW
PHASE 4 LPI	R	R	R	R	R	R	R	R	DW	DW	WK	WK
PHASE 4 ALT	R	R	R	R	R	R	G	G	DW	DW	WK	WK
PED CLEARANCE	R	R	R	R	R	R	G	G	DW	DW	FL/DW	FL/DW
PHASE 4 ALT CHANGE	R	R	R	R	R	R	Y	Y	DW	DW	DW	DW
FLASHING OPERATION	FL/Y	FL/Y	FL/Y	FL/Y	FL/Y	FL/Y	FL/R	FL/R	DARK	DARK	DARK	DARK

WIRING DIAGRAM

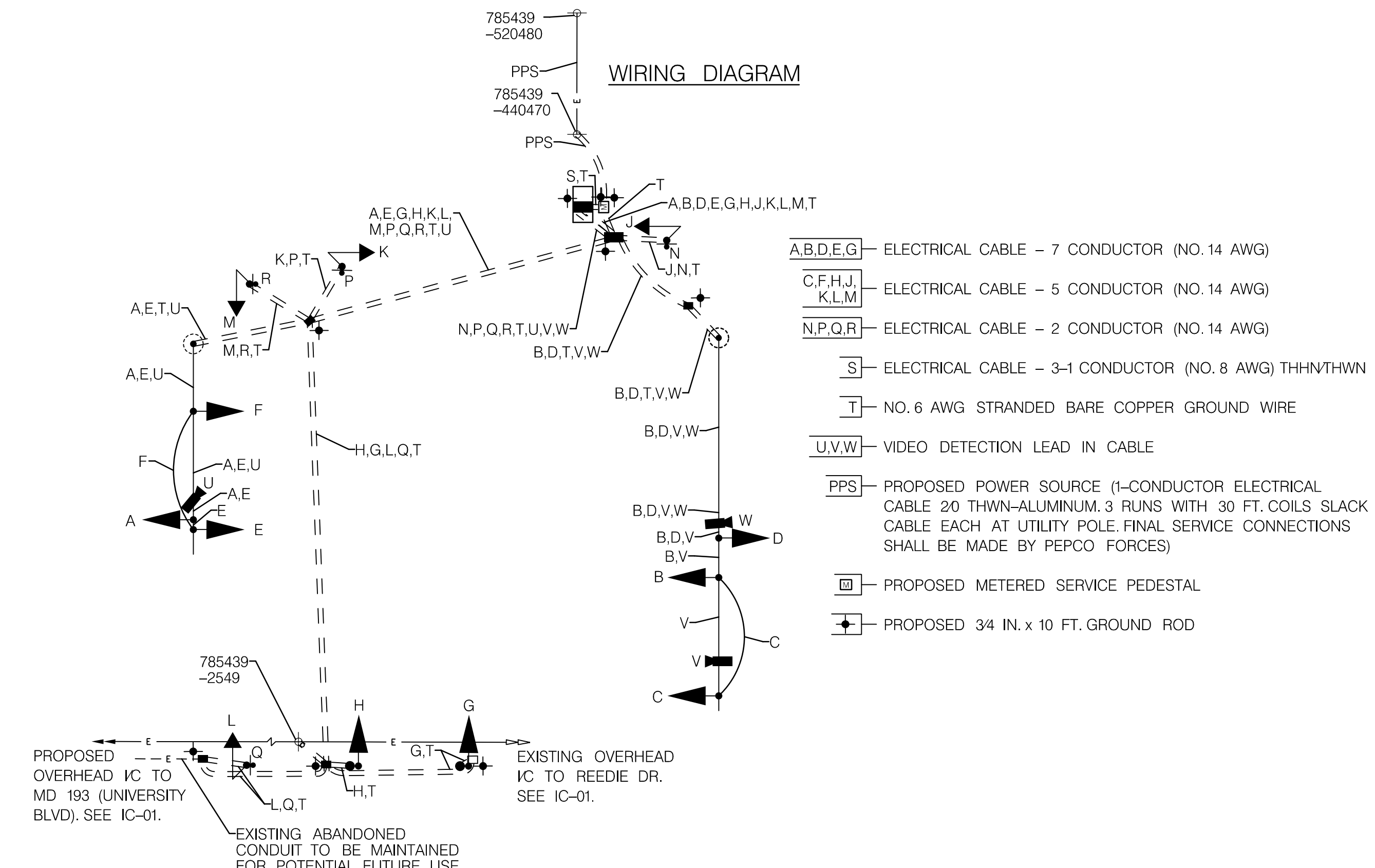

ACCESS PERMIT NUMBER 20APMO037XX.
IF CONSTRUCTION IS NOT STARTED WITHIN ONE YEAR OF APPROVAL,
CONSTRUCTION SHALL NOT START UNTIL PLANS ARE REAPPROVED.

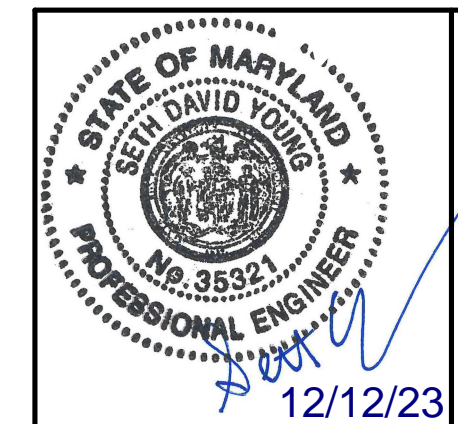

"I HEREBY CERTIFY THAT THESE DOCUMENTS WERE PREPARED OR APPROVED BY ME, AND THAT I AM A DULY LICENSED PROFESSIONAL ENGINEER UNDER THE LAWS OF THE STATE OF MARYLAND."
LICENSE NO. 35321
EXPIRATION DATE JANUARY 6, 2024

OFFICE OF TRAFFIC & SAFETY
TRAFFIC ENGINEERING DESIGN DIVISION

MOT
MARYLAND DEPARTMENT OF TRANSPORTATION
STATE HIGHWAY ADMINISTRATION

MD 97 (GEORGIA AVENUE) AND PRICE AVENUE
WHEATON, MARYLAND

GENERAL INFORMATION SHEET

SCALE NONE ADVERTISED DATE _____ CONTRACT NO. _____

DESIGNED BY K. MISNER COUNTY MONTGOMERY
DRAWN BY K. MISNER LOGMILE 15009703.37
CHECKED BY M. GUILIANO TMS NO. P037
MDE/PRD TOD NO. _____

TS NO. 5264 DRAWING SG-03 OF 04 SHEET NO. 3 OF 4

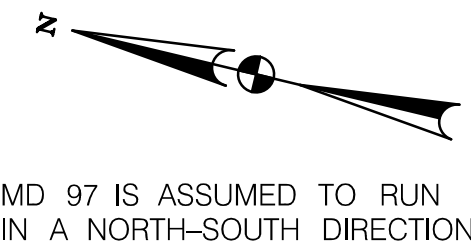

MD 97 IS ASSUMED TO RUN IN A NORTH-SOUTH DIRECTION

- A—PULL BACK EXISTING SELF-SUPPORTING 12-PAIR COMMUNICATION CABLE FROM REEDIE DRIVE FROM EXISTING SPLICE CABINET AT MD 193, AND REROUTE TO PROPOSED SIGNAL CABINET AT PRICE AVENUE
- B—NEW SELF-SUPPORTING 12-PAIR COMMUNICATION CABLE FROM PROPOSED SIGNAL CABINET AT PRICE AVENUE TO EXISTING POLE MOUNTED SPLICE CABINET AT MD 193.

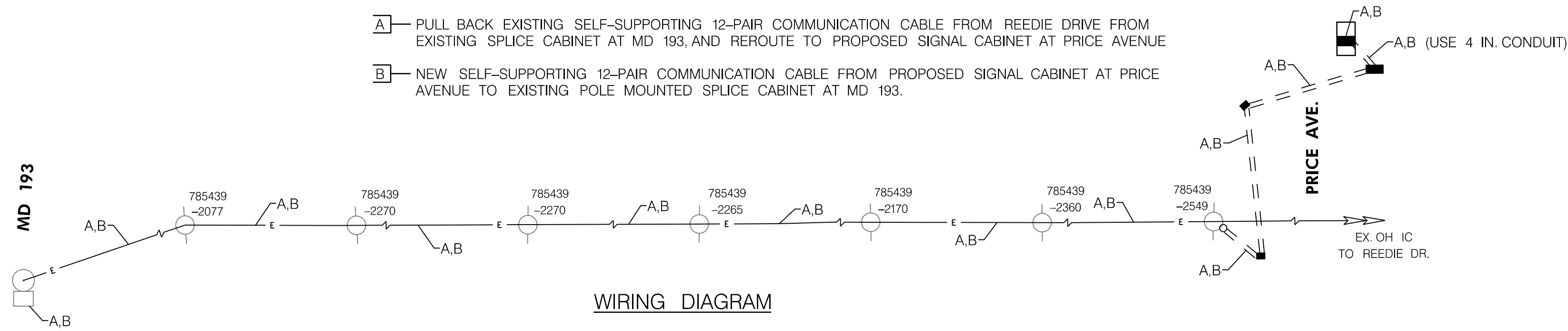

WIRING DIAGRAM

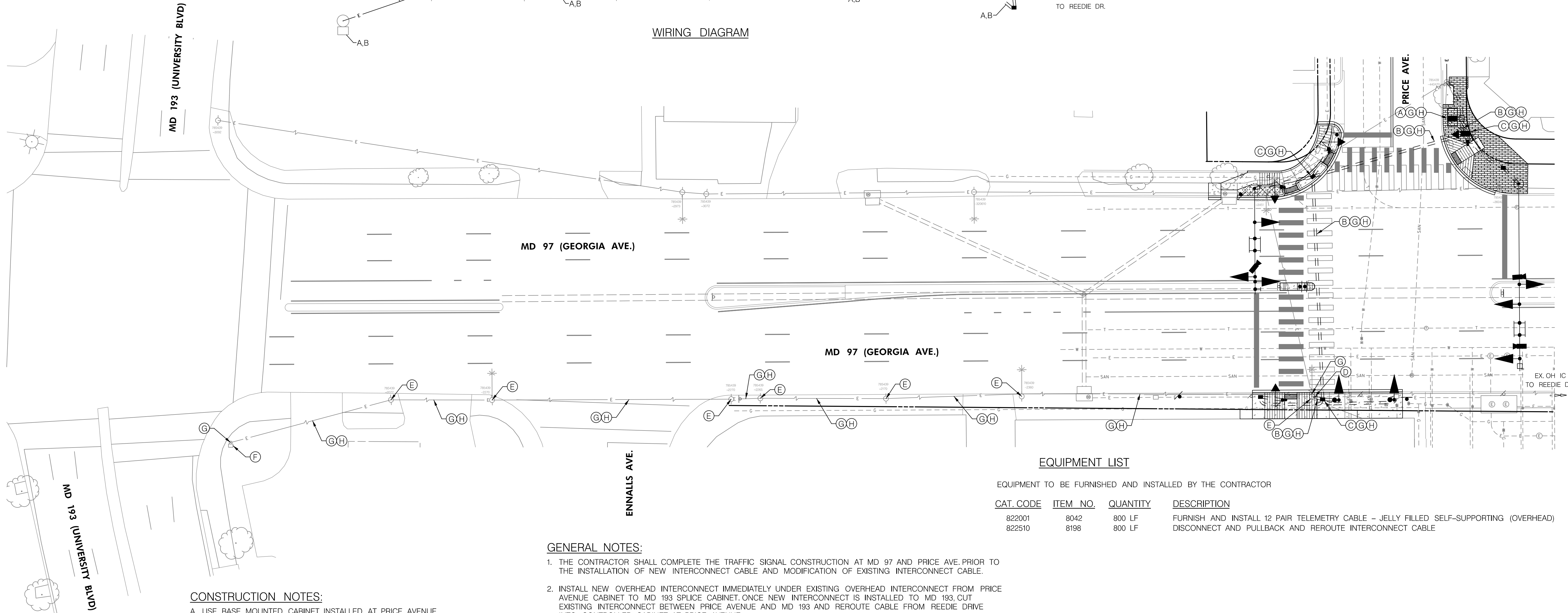

EQUIPMENT LIST

EQUIPMENT TO BE FURNISHED AND INSTALLED BY THE CONTRACTOR

CAT. CODE	ITEM NO.	QUANTITY	DESCRIPTION
822001	8042	800 LF	FURNISH AND INSTALL 12 PAIR TELEMETRY CABLE - JELLY FILLED SELF-SUPPORTING (OVERHEAD)
822510	8198	800 LF	DISCONNECT AND PULLBACK AND REROUTE INTERCONNECT CABLE

GENERAL NOTES:

- THE CONTRACTOR SHALL COMPLETE THE TRAFFIC SIGNAL CONSTRUCTION AT MD 97 AND PRICE AVE. PRIOR TO THE INSTALLATION OF NEW INTERCONNECT CABLE AND MODIFICATION OF EXISTING INTERCONNECT CABLE.
- INSTALL NEW OVERHEAD INTERCONNECT IMMEDIATELY UNDER EXISTING OVERHEAD INTERCONNECT FROM PRICE AVENUE CABINET TO MD 193 SPLICE CABINET. ONCE NEW INTERCONNECT IS INSTALLED TO MD 193, CUT EXISTING INTERCONNECT BETWEEN PRICE AVENUE AND MD 193 AND REROUTE CABLE FROM REEDIE DRIVE INTO CONTROLLER CABINET AT PRICE AVENUE.
- DISCONNECTION, CUTTING AND SPLICING OF INTERCONNECT CABLE IN THE TRAFFIC SIGNAL CABINET AND SPLICE BOXES SHALL BE PERFORMED BY MONTGOMERY COUNTY FORCES. THE CONTRACTOR SHALL COORDINATE THESE EFFORTS WITH THE PROJECT ENGINEER.
- THE CONTRACTOR IS RESPONSIBLE FOR ROUTING AND LABELING INTERCONNECT CABLE AT TERMINATION POINTS. CONTACT MR. KAMAL HAMUD AT (240-777-8761) FORTY-EIGHT (48) HOURS IN ADVANCE OF INTERCONNECT WORK.
- MAINTENANCE OF TRAFFIC WILL BE HANDLED BY THE CONTRACTOR UTILIZING MDOT-SHA STANDARD PLATES FOR TRAFFIC CONTROL.
- ALL UNDERGROUND AND OVERHEAD UTILITIES SHOWN ON THESE PLANS ARE APPROXIMATE AND MAY NOT BE COMPLETE. IF ANY UTILITY CONFLICTS SHOULD ARISE, THE CONTRACT SHALL CONTACT THE PROJECT ENGINEER.
- THE CONTRACTOR SHALL REMOVE THE SELF-SUPPORTING PORTION OF THE CABLE WHEN INTERCONNECT CABLE TRANSITIONS FROM AERIAL TO UNDERGROUND.

CONSTRUCTION NOTES:

- USE BASE MOUNTED CABINET INSTALLED AT PRICE AVENUE
- USE CONDUIT INSTALLED FOR PRICE AVENUE SIGNAL.
- USE HANDHOLE INSTALLED FOR PRICE AVENUE SIGNAL.
- USE RISER INSTALLED ON EX. UTILITY POLE.
- USE EXISTING UTILITY POLE.
- USE EXISTING SIGNAL POLE AND POLE MOUNTED SPLICE CABINET.
- DISCONNECT, CUT, PULLBACK & REROUTE EXISTING OVERHEAD INTERCONNECT CABLE FROM REEDIE DRIVE FROM POLE MOUNTED SPLICE CABINET AT MD 97 & MD 193 TO PROPOSED SIGNAL CABINET AT PRICE AVENUE. (SEE NOTES 2 & 3)
- INSTALL NEW SELF-SUPPORTING INTERCONNECT CABLE FROM PROPOSED SIGNAL CABINET AT PRICE AVENUE TO EX. POLE MOUNTED SPLICE CABINET AT MD 97 & MD 193. (SEE NOTES 2 & 3)

ACCESS PERMIT NUMBER 20APM0037XX.
IF CONSTRUCTION IS NOT STARTED WITHIN ONE YEAR OF APPROVAL, CONSTRUCTION SHALL NOT START UNTIL PLANS ARE REAPPROVED.

OFFICE OF TRAFFIC & SAFETY
TRAFFIC ENGINEERING DESIGN DIVISION

STATE HIGHWAY ADMINISTRATION

MD 97 (GEORGIA AVENUE)
AND PRICE AVENUE
WHEATON, MARYLAND

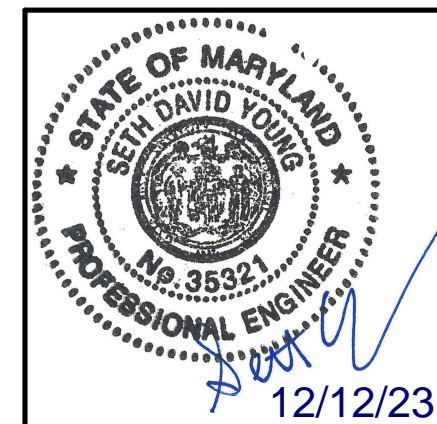

"I HEREBY CERTIFY THAT THESE DOCUMENTS WERE PREPARED OR APPROVED BY ME AND THAT I AM A DULY LICENSED PROFESSIONAL ENGINEER UNDER THE LAWS OF THE STATE OF MARYLAND."
LICENSE NO. 35321
EXPIRATION DATE JANUARY 6, 2024

APPROVALS	REVISIONS
TEAM LEADER	
ASST. DIV. CHIEF	
DIVISION CHIEF	
OFFICE DIRECTOR	

INTERCONNECT PLAN

SCALE 1" = 20' ADVERTISED DATE _____ CONTRACT NO. _____

DESIGNED BY K. MISNER COUNTY MONTGOMERY
DRAWN BY K. MISNER LOGMILE 15009703.37 TO 15009703.47
CHECKED BY M. GUILIANO TMS NO. P037
MDE/PRD _____ TOD NO. _____

TS NO. 5264 DRAWING SG-04 OF 04 SHEET NO. 4 OF 4



BY: misnerkm